

Exclusive Charter



York Regional Chamber presents

Burgundy & Provence France River Cruise

featuring 7 nights aboard the Amadeus Provence

9 Days **October 25, 2023**



Kittery
Eliot
York
South Berwick
Cape Neddick



MEMBER SAVINGS!

Save \$100 per person

BOOKING DISCOUNT!

Save \$200 per person
\$400 per couple*

*See Reservation Info for
Booking Discount details



9 Days **October 25, 2023**

Burgundy & Provence France River Cruise

Day 1&2 Depart US - Overnight Flight to Europe - Arrive Lyon - Board Ship
Arrive Lyon & meet your **CE Tour Manager** - Transfer to the **MS Amadeus Provence** for 7 night cruise - **Welcome Dinner Onboard** - Ship departs north late evening
(D) *Overnight - Amadeus Provence*

Day 3 Mâcon
Morning **Mâcon Walking Tour**
Afternoon *Wine Region with Tasting Experience Optional*
(B,D) *Overnight - Amadeus Provence*

Day 4 Chalon sur Saone - Beaune - Tournus
Morning **Beaune, Hotel-Dieu & Burgundy Wine Tasting Experience**
Afternoon *Medieval Brancion & Cormatin Optional* - Ship arrives in **Tournus**
(B,L,S & D) *Overnight - Amadeus Provence*

Day 5 Lyon
Morning **Lyon City Tour with Old Town**
Afternoon Cruising - Ship departs Lyon & heads south towards Avignon
(B,L,S & D) *Overnight - Amadeus Provence*

Day 6 Avignon
Morning **Avignon Walking Tour** including **Palace of the Popes**
Afternoon at leisure in Avignon or *Pont du Gard & Uzès Optional*
(B,L,S & D) *Overnight - Amadeus Provence*

Day 7 Arles
Morning **Arles Walking City Tour with Roman Amphitheatre**
Afternoon at leisure in Arles or *Camargue Nature Park Optional*
(B,L,S & D) *Overnight - Amadeus Provence*

Day 8 Leisure Day with Châteauneuf-du-Rhône/Ardeche - Le Pouzin
Relax Onboard/Leisure Day - *Morning Optional Excursion to Ardèche Gorge*
Midday ship stops in **Le Pouzin** - Afternoon Cruising - **Gala Farewell Dinner**
(B,L,S & D) *Overnight - Amadeus Provence*

Day 9 Lyon - Flight Home
Transfer to the Lyon Airport to fly home or join Paris Post Cruise Extension
(B)

B-Breakfast Hotel/Onboard • S-Snacks Onboard afternoon and/or evening
L-Lunch Onboard • D-Dinner Onboard with Beer & Regional Wines

Optional 2-Night Paris Post Cruise Extension \$795 pp dbl +\$400 single supplement

Day 9/Nov 2 Disembark Lyon - Dijon - Paris
Disembark & travel north via motorcoach enroute to Paris. Stop in **Dijon** for a tour and continue on to Paris, "The City of Light", for a 2 Night Stay
(B - on ship) *Overnight - Paris*

Day 10/Nov 3 Paris
Morning **Paris City Tour & Seine Cruise** - see Notre Dame Cathedral, Arc de Triomphe, Champs Elysees & the Eiffel Tower then a Seine River Cruise - *Afternoon at Leisure*
(B) *Overnight - Paris*

Day 11/Nov 4 Transfer to Paris Airport (CDG) - Flight Home
(B)

Optional Paris POST Cruise Extension Includes: 2 Nights Hotel - Paris, Paris City Tour, Seine River Cruise, CE Tour Manager, 2-Breakfasts & Transfer from Lyon to Paris with Dijon Tour, Transfers to Paris Airport (CDG). Due to group air policies outbound air on 10/25 could be a different schedule than the rest of the your group for Paris extensions passengers. • Paris extension is based on 20 passenger minimum.

CITIES & PORTS

Lyon

Lyon, a city in France's historical Rhône-Alpes region, sits at the junction of the Rhône & Saône Rivers with a history dating back to ancient Roman times. Lyon has earned a place on the UNESCO World Heritage list as the city boasts France's oldest ancient ruins, medieval quarters and fine Renaissance houses.

Mâcon

Enjoy an included Macon Walking Tour, a city with a Mediterranean feel on the banks of the Saône, Mâcon is famous for its wine. Two thirds of the wine is white, coming from the Chardonnay grape with Pouilly-Fuissé, St-Véran and Mâcon-Villages Blanc being the most famous. The other third is red or rosé from the Gamay or Pinot Noir grape. From Mâcon enjoy an included excursion featuring scenic vineyards & a wine tasting.

Beaune & Burgundy

Travel to **Beaune** to explore this walled town at the center of the Burgundy wine making region in France. Surrounded by the Côte d'Or vineyards, the cobbled town is renowned for an annual wine auction held at the **Hôtel-Dieu**. Recognized by its colorful, geometric-patterned tile roof, this former hospital is now the Hôtel-Dieu Museum & remains one of the finest examples of French 15th-century architecture. After the tour, enjoy a **Wine Tasting Experience** to sample the local product of the Burgundy Wine Region.

Chalon sur Saone & Tournus

Chalon-sur-Saone, a town of historic & artistic interest, is situated in the Saone-et-Loire, Burgundy region in the eastern-center of France. Tournus is tucked away in the southeast corner of Burgundy, this delightful town has a wealth of old buildings, alleyways, antique shops, cafes and restaurants.

Avignon

Avignon, nicknamed "City of Popes" because it was home to seven popes from 1309 to 1377. Your **Avignon Walking Tour** includes a stroll through the historic center, the picturesque Pont d'Avignon and the Place de l'Horloge. Continue to the renowned **Palace of the Popes** for a guided tour through this rambling maze of Gothic architecture that served as papal residence, fortress, church and palace.

Arles

Arles is the site of some impressive ruins including Les Arènes, a **Roman Amphitheatre** that seats 20,000 and is still in use, as well as Romanesque monuments such as the Church of Saint-Trôphime, completed in the 15th century. Enjoy an **Arles Walking Tour** with its diverse architectural highlights. Experience the city's vibrant colors and striking quality of light that have inspired artists. An excursion is available to the Camargue Nature Park, famous for its white horses.

Le Pouzin

Today is a day to relax onboard. Stop in Le Pouzin, a charming town on the banks of the Rhone. An Ardèche Gorge optional is available, often referred to as the Grand Canyon of Europe with its towering limestone cliffs.

Paris (Optional Post Cruise Extension)

Paris, the "City of Light" is the world's most visited capital. Enjoy a Paris City Tour & Seine River Cruise to see the beloved landmarks that line the Seine including the Notre Dame Cathedral, the Louvre and the Eiffel Tower. Also see the majestic Arc de Triomphe and ride along the Champs-Élysées. During your afternoon at leisure visit the Montmartre District, the Louvre or wander the historic banks of the Seine which are a UNESCO World Heritage Site.



Amadeus Provence



Fine Dining



Infinity Pool

MS AMADEUS PROVENCE DECK PLAN

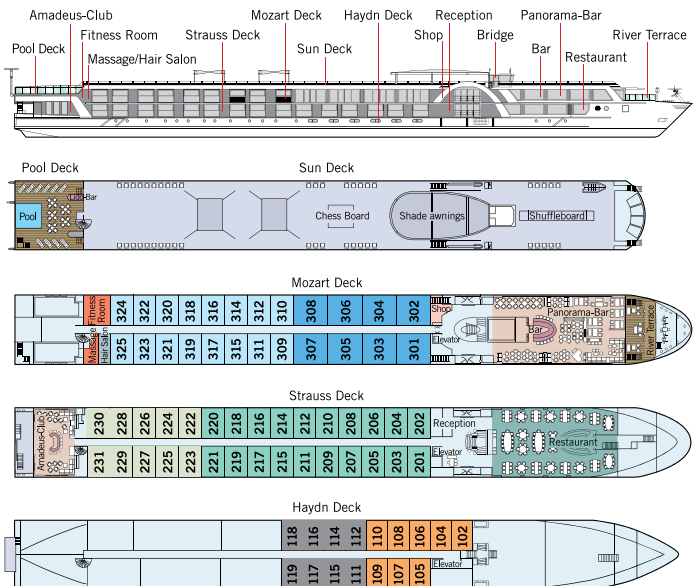

INCLUSIONS

- Roundtrip Airfare - BOS
- Roundtrip Transfers - BOS
- 7 Night Cruise - Outside Cabin
- 20 Meals (7-B, 6-L, 7-D)
- CE Tour Manager
- Wine & Beer with Dinners
- Welcome & Farewell Dinners
- Wifi Onboard
- English Speaking Ship Staff
- Baggage Handling
- Int'l Air Taxes/Fees & Port Charges
- Hotel & Ship Transfers

EXCURSIONS/TOURS

- Beaune Tour with Hotel-Dieu & Burgundy Wine Tasting Experience
- Macon Walking Tour
- Lyon City Tour
- Avignon Walking Tour with Avignon Palace of Popes
- Arles Walking Tour with Roman Amphitheatre

RATES

Cat E - Haydn Deck	\$4895 pp dbl*	\$4695 pp dbl with BD**	+\$1200 single
Cat D - Haydn Deck	\$5095 pp dbl*	\$4895 pp dbl with BD**	+\$1200 single
Cat C - Strauss Deck	\$5495 pp dbl*	\$5295 pp dbl with BD**	+\$1600 single
Cat B - Strauss Deck	\$5695 pp dbl*	\$5495 pp dbl with BD**	+\$1600 single
Cat A - Mozart Deck	\$5895 pp dbl*	\$5695 pp dbl with BD**	+\$2000 single
Suite - Mozart Deck	\$6395 pp dbl*	\$6195 pp dbl with BD**	+\$2400 single

*Regular Rate or **Save \$200 per person/\$400 per couple with Booking Discount Rates (BD)

STATEROOMS & SUITES



STATEROOMS - 172 or 188 SQ FT

All staterooms feature 2 twin beds that can be separated or put together, flat screen TV, shower, hair dryer, closet, phone, desk, chair & safe. Mozart & Strauss Staterooms feature panoramic Drop-Down Windows with 188 sq ft. of floor space. Haydn Deck Staterooms feature a Fixed Window with 172 square feet of floor space. (stateroom size & amenities can vary)



SUITE - 284 SQ FT WITH BALCONY

All suites are on the Mozart Deck and have panoramic windows with exterior Walk Out Balcony, two twin beds that can be separated or put together, a private sitting area, flat screen TV, mini-bar, private bath with shower, hair dryer, phone, closet, desk, chair, safe & offer 284 square feet of floor space. (Suite size and amenities can vary)

Stateroom Haydn Deck (172 sf)

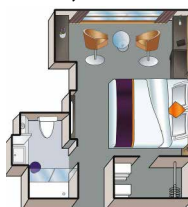

Stateroom Strauss & Mozart Decks (188 sf)



Suite Mozart Deck (284 sf)



The Ship - MS Amadeus Provence

Launched in 2017, the innovative 140-passenger Amadeus Provence offers all the amenities of a floating 5-star hotel. This Premium cruise ship features the most modern furnishings that blend masterfully with the architecture of the ship and a luxurious design that is the hallmark of the Amadeus fleet. The extensive Restaurant and the Panorama Bar offer divine views of the passing riverscapes, and the outdoor, glass-shielded River Terrace allows you to relax in the open air regardless of the weather. The attentive English Speaking onboard service staff will see to your comfort with typical European hospitality. The cabin design plans are forward-thinking, bright & modern, all part of a premium focus with 62 large Staterooms & 8 Suites. The beauty of river cruising is that the most interesting destinations come to you. This Provence charter features English-only onboard commentary with inclusive sightseeing excursions balanced with choice to simply relax onboard, get a spa treatment or add sightseeing with optional excursions.

All Meals Included Onboard

Three meals daily are served graciously in the exquisite restaurant and feature local & international specialties. All dinners are four courses and served with included regional wines, beer & soft drinks. While dining, you have splendid views of the passing scenic landscapes through large picture windows. Enjoy afternoon and/or late evening snacks in the lounge based on the daily schedule.

Comfortable & Innovative Staterooms

After boarding, unpack once. All staterooms are larger than traditional river cruise cabins & offer excellent river views. The Mozart Deck features 8 Suites with Walk Out Balconies. The other 16 Staterooms on the Mozart Deck & 30 Staterooms on the Strauss Deck feature an innovative Panoramic Drop-Down Window. Staterooms on the Haydn Deck have a large fixed window. Each luxury stateroom is fully equipped with comfortable & modern furnishings including flat screen TV & large private bathrooms with shower.

TECHNICAL DATA

Built in:	2017	Crew members:	40
Decks:	4	Cabins/Suites:	62/8
Length/Width (ft):	361/36.5	Max Passengers:	140

Reservation Form (River Cruise) Burgundy & Provence France River Cruise October 25, 2023 Booking #164842 (Web Code)	Contact Information/Mail Reservation Form to: York Reginal Chamber • Attn: Linda Chisholm 1 Stone Wall Lane York, ME 03909 207.363.4422 • linda@yorkme.org
--	---

Cabin Category Requested: *(All Cabin Categories are on a space available basis)*

Cat E: ☐ Cat D: ☐ Cat C: ☐ Cat B: ☐ Cat A: ☐ Suite: ☐

Enclosed please find a deposit in the amount of \$ _____ (\$500 per person) to secure reservations for _____ # of people.

Premier's Travel Protection Plan (TPP): ☐ Yes, I (we) wish to purchase travel protection (TPP)
(TPP must be purchased with initial deposit) ☐ No, I (we) decline travel protection (TPP)

Enclosed please find payment in the amount of \$ _____ (\$475 per person) to secure the Premier's Travel Protection Plan (TPP).

I / we want to purchase the Paris Post Extension*** (\$795 pp dbl/+\$400 SS) ☐ Yes ☐ No
***Please book Prague Ext with initial deposit.

TOTAL PAYMENT \$ _____ Make checks payable to: CHAMBER EXPLORATIONS

RT AIR GATEWAY _____ ROOMMATE'S RT AIR GATEWAY _____
see flyer page 3 for included group RT gateway/departure city, additional charges apply for other RT air packages

To avoid change fees, submit Passport names (first/mid/last) exactly as they appear on Passports

Passport Name: _____

DOB (MM/DD/YY) _____ Gender ☐ M ☐ F

Passport #: _____ Exp Date (MM/DD/YY) _____

Country of Issuance _____

Roommate's Passport Name: _____

DOB (MM/DD/YY) _____ Gender ☐ M ☐ F

Roommate's Passport #: _____ Exp Date (MM/DD/YY) _____

Country of Issuance _____

Street Address _____ ☐ Check if Roommate's address is the same

City _____ State _____ ZIP _____

Email address _____

Mbl# _____

Emergency Contact/Tel# _____

Notes: _____



Cardholder Name (If paying by credit card) _____

Credit Card # _____ Exp Date: _____

CVV# _____ Amount to be charged \$ _____

Credit Card Billing Address: ☐ Check if address is the same as above

Address _____ City _____

State _____ ZIP _____ Tel# _____

Sign _____ Date _____

SIGNATURE REQUIRED (for credit card use & acceptance of terms*)

**I (We) agree to pay according to the credit card issuer agreement. I understand and accept the cancellation fees/policy and other terms.*

DEPOSIT & FINAL PAYMENT

An Initial Deposit of \$500 per person is due with Reservation Form to secure reservations. Final Payment Due Date is 90 days prior to departure.

*BOOKING DISCOUNT

Make your Final Payment by check prior to the Final Payment Due Date

& receive **\$400 per couple/\$200 per person Booking Discount!**

• Initial Deposit can be made by check or credit card to be eligible.

• Payments after Initial Deposit are part of Final Payment & must be made by check.

ONLINE BOOKING OPTION

Save time, postage & secure your seat for this group departure. Simply type: <https://res.chamberexplorations.com> into your web browser & use the Booking Number (Web Code) from this flyer to make your Deposit online in just a few minutes. No need to submit a Reservation Form if booking online.

PREMIER'S TRAVEL PROTECTION PLAN (TPP) \$475 per person

(must purchase with Initial Deposit)

Part A – Cancellation Waiver provided by CE

I. Trip Cancellation Waiver (TCW) - Guarantees full refund on all payments, except the Trip Cancellation Waiver Fee itself in case of cancellation up to the time and date of departure due to the passenger's personal illness or death of an immediate family member. Medical/official documentation required.

II. Premier "Any Reason" Cancellation Waiver (ARCW) - Reimburses 75% of the cancellation fees in the form of a future travel credit certificate (FTCC) valid for 1 year, if you cancel more than 48 hours prior to scheduled departure for any reason not eligible for cash refund under the TCW (Part A – I.). FTCC is non-transferable, may not be redeemed for cash and does not include any credit for the Trip Cancellation Waiver Fee. **The Trip Cancellation Waiver Fee must be paid for with Initial Deposit and is refundable until 180 days prior to departure. The Trip Cancellation Waiver does not cover any single supplement charges due to an individual's traveling companion canceling prior to departure.** The Trip Cancellation Waiver is non-transferable and valid for each applicant only. The Trip Cancellation Waiver does not cover any services such as airline tickets not purchased through CE. Cancellations, Refunds & Inquiries under Part A will be handled by CE. Certain Exclusions and Restrictions apply.

Part B – Post Departure Travel Protection Plan* provided by USI

Includes coverage for: Trip Interruption (\$1,000); Trip Delay (\$100/Day-Max \$500); Baggage & Personal Effects (\$2,000); Baggage Delay (\$500); Emergency Evacuation/Sickness Medical Expense- excess coverage (\$30,000); Emergency Evacuation/Repatriation (\$150,000); Accidental Death & Dismemberment (\$25,000); Non-Insurance and Emergency Travel Assistance Services** (24/7). Claims & Inquiries under Part B will be administered by USI.

For full Part A and Part B plan details visit: premierworlddiscovery.com/TPP
All Benefits described on this page are for general information basis only. There are certain restrictions, exclusions and limitation that apply to all insurance coverages. Plan benefits, limits and provisions may vary by state jurisdiction.

CANCELLATION FEES

Cancellations are subject to the following per person fees;

- Cancel 180 days prior to departure: \$200 pp is retained
- Cancel 179-90 days prior to departure: Deposit or TPP** is retained
- Cancel 89-60 days prior to departure: 50% of total price
- Cancel 59-30 days prior to departure: 75% of total price
- Cancel 29 days or less prior to departure/no shows: No refunds

**If TPP purchased

RESPONSIBILITY

Premier World Tours LLC dba Chamber Explorations (hereafter PWD/CE), whose vouchers are used by respective agents for the passenger in all matters pertaining to hotel accommodations, sightseeing tours and transportation, hold themselves free of responsibility for any damages occasioned from any cause whatsoever. PWD/CE will not be responsible for any damages or inconveniences caused by late arrivals, departures and change of schedule or other conditions nor will they be responsible for any act, omission, or event during the time the passenger is not on board their conveyance PWD/CE. The passage contract in use by the airline on PWD/CE, when issued, shall constitute the sole contract between the airline and the purchaser of this tour/cruise, and/or passenger. PWD/CE does not hold any responsibility for the conduct of any of its members, hotel, motorcoach, cruiseline, train, airline or other personnel. PWD/CE reserves the right to decline to accept PWD/CE or retain any person as a member of a tour/cruise at its discretion. PWD/CE &/or its Tour Director retain the right to require any participant to withdraw from a tour/cruise at any time, if determined to be in the best interests of health, safety & general welfare of the tour/cruise group or of the individual participant. Arbitration- I/We agree, any and all disputes on PWD/CE, this contract or any other material on PWD/CE, the trip, or the trip itself must be resolved exclusively pursuant to binding arbitration in the state of California, pursuant to the then current rules of the American Arbitration Association. Payment of the deposit for this tour/cruise constitutes acceptance of PWD/CE of these terms and conditions. CST #2048841-40

IMPORTANT CONDITIONS/NOTES

• A valid US passport is required for this tour and is the responsibility of each passenger. Passports should be valid for up to six (6) months beyond the travel dates. All names must be submitted to Premier exactly as they appear on passenger passports.

• Itinerary and hotels are subject to change.

AIR NOTE

Air Schedules may not be available until Final Trip Documentation is received. Air seats are assigned by the airline and sometimes not assigned until the day of travel. Air seat changes can only be attempted upon receipt of e-tickets and Final Trip Documentation at which time availability may be limited. If specific seat assignments or airline choice is extremely important to your reservation, we recommend you book land only and make your own air reservations. Please make this adjustment to land only/own air at time of tour reservation.

